

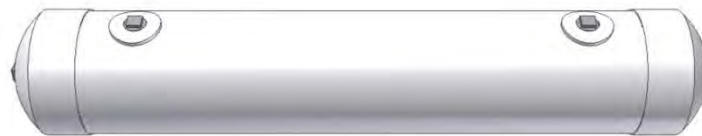

"Innovative Solutions for A Better Life"

UF S-630 : 7-Bores Capillary Ultrafiltration Module



DIMENSION	Nominal Diameter	6 inch
	Length	790 mm
	Feed/Concentrate Connection	1"
	Permeate Connection	3/4"
	Weight	10 kg
FEATURES	Permeate Capacity	700 - 1200 liter/hour
	Permeate Turbidity	<3 NTU
	Filtration Mode	Lumen to Shell (Cross Flow)
	Membrane Material	Polysulfone
	7 Bores Fiber ID	0,9 mm
	Effective Surface Area	$\pm 6,5 \text{ m}^2$
	Potting Material	Epoxy Resin
	Housing Material	PVC
	Storage Solution	0,1% Sodium Metabisulfite
	OPERATION	Operating pressure
Operating temperature		max. 50 °C
CHEMICAL CLEANING	Acidic Cleaning	0,1% HCl solution
	Caustic Cleaning	0,1% NaOH solution
	<i>*For best cleaning result, please consult GDP Filter</i>	

The information contained in this publication is believed to be accurate and reliable, but is not to be construed as implying any warranty or guarantee of performance. We assume no responsibility, obligation or liability for results obtained or damages incurred through the application of the information contained herein.

GDP Filter - Filtration and Separation System

Jl. Cihanjuang No. 124 Km. 2,5 - Bandung 40559, Indonesia

Ph. : (022) 6648498, Fax. : (022) 6652139, E-mail : support@gdpfilter.co.id; Web : www.gdpfilter.co.id